

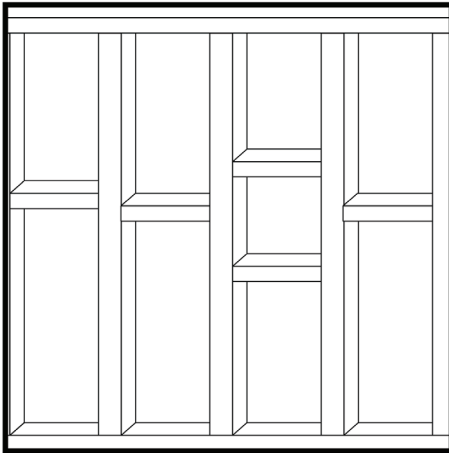

# UNIVERSAL HABITAT

Niche

INSTALLATION INSTRUCTIONS



### Step 1

Add extra framing in desired position to wall frame to support and match dimensions of the Niche. Ensure all framing is level and all four sides are supported

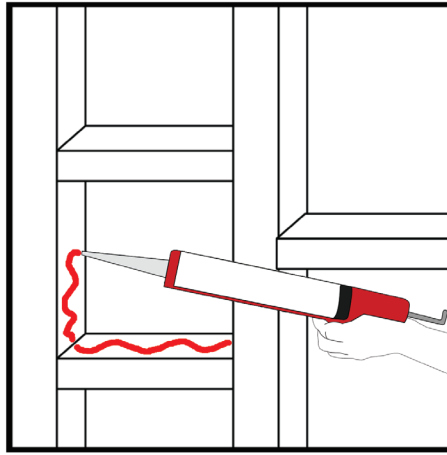

### Step 2

Apply polyurethane sealant adhesive (fast cure) to all noggins/studs in a continuous snake like bead.

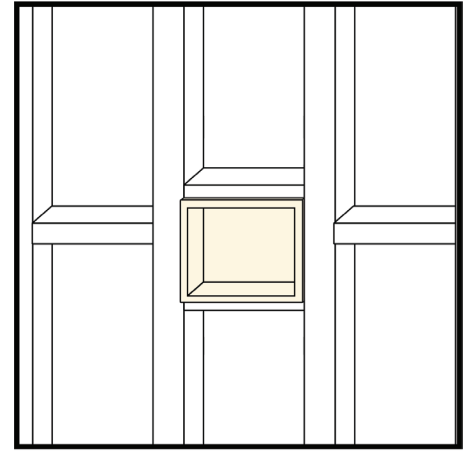

### Step 3

Insert Niche so all edges will be flush with the face of the wall sheeting and edge with fall is facing to the bottom.

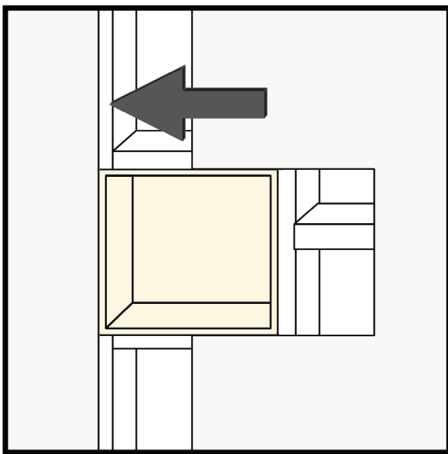

### Step 4

Install wallboard to finish flush with the edges of the niche. Please note: once installed you can trim the Niche using a stanley knife.

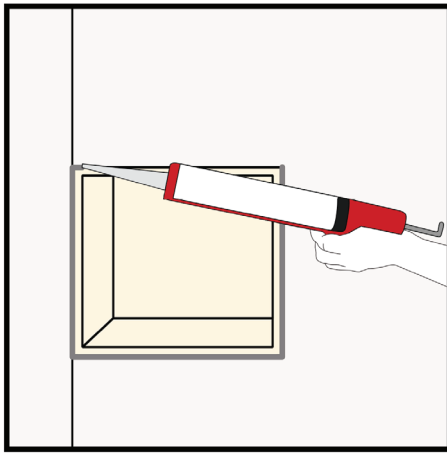

### Step 5

Seal any gaps between wallboard and niche by applying polyurethane sealant adhesive (fast cure) around the niche.

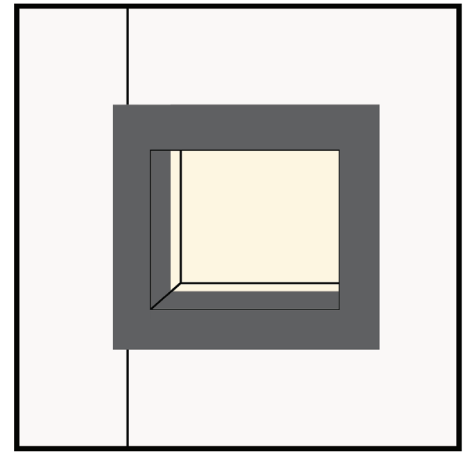

### Step 6

Apply waterproof membrane, bandage to overlay the inside and outside surfaces of the Niche and Wallboard by minimum of 40mm.

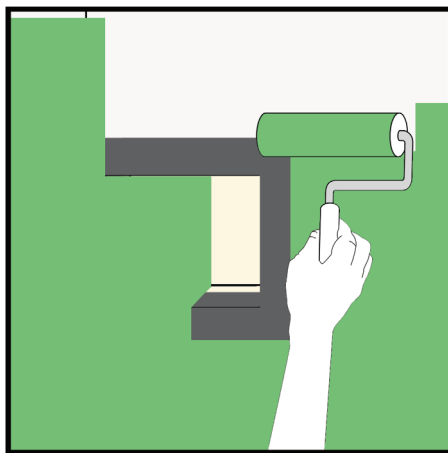

### Step 7

Apply a waterproof membrane over the Niche and walls in accordance with manufacturer's instructions. Please note: It is recommended that a test patch is conducted first to ensure adequate adhesion.

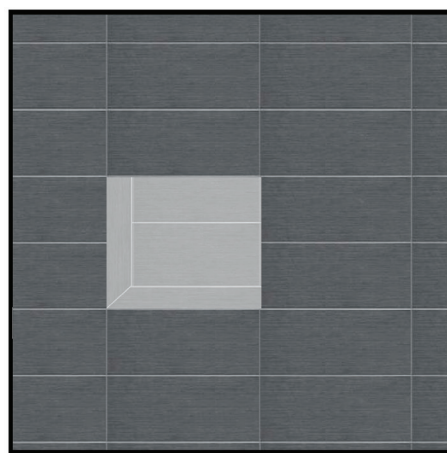

### Step 8

The Niche is now ready to tile. To ensure proper adhesion it is recommended that the same brand of tile adhesive and waterproofing membrane are used as per manufacturer's instructions.

MADE BY\_\_UNIVERSAL

Built with care.

We avoid wasteful paper usage and encourage  
you to explore our range of products online.

03 9791 8925  
INFO@UNIVERSALHABITAT.COM  
315 TOORADIN STATION RD, TOORADIN VIC 3980

**UNIVERSAL HABITAT**